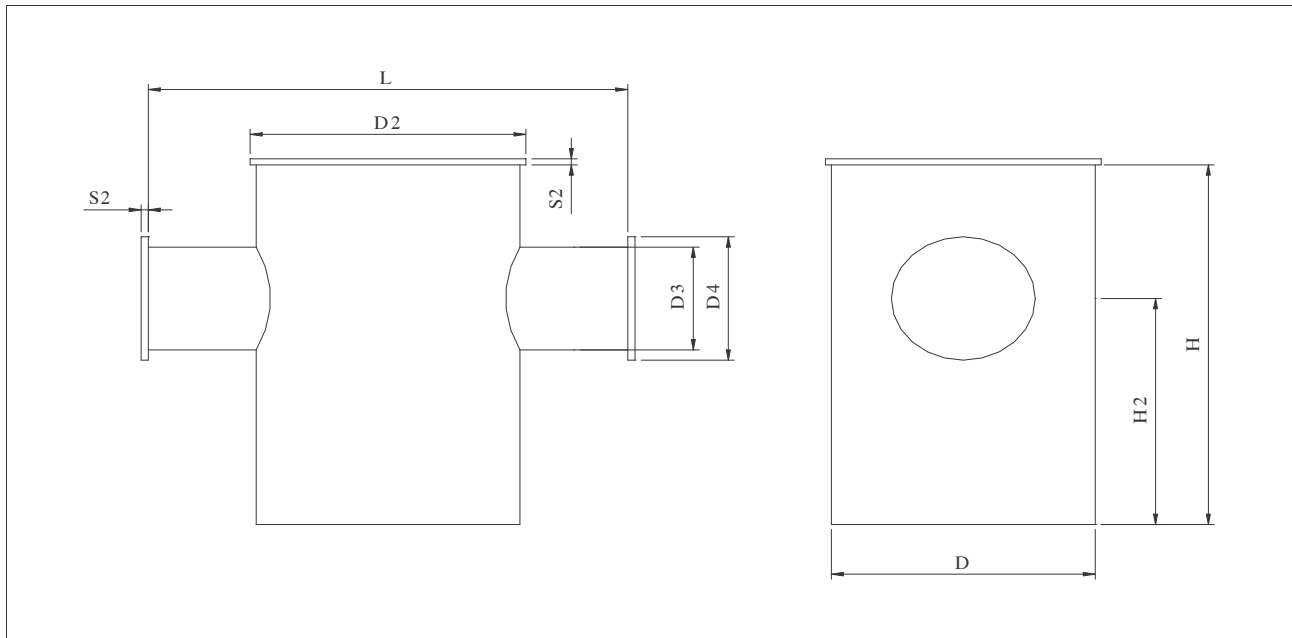

PRODUCTSHEET**Cruciform Bollards**

Product nr	Product name	Product type	Nom Pull (SWL) (kN)	L (mm)	H (mm)	D1 mmxmm	D2 (mm)	D3 (mm)	D4 (mm)	H2 (mm)	S2 (mm)	Weight (kg)
04 00189	Cruciform Bollard	CB-01	10	210	175	114,3 x 6,0	125	54,0 x 6	67	99	6,5	5
04 00190	Cruciform Bollard	CB-02	20	230	190	127,0 x 6,0	139	60,3 x 6	75	108	6,5	6
04 00191	Cruciform Bollard	CB-03	30	255	210	139,7 x 6,0	153	63,5 x 8	79	118	8,5	9
04 00192	Cruciform Bollard	CB-05	50	400	330	219,1 x 6,0	240	101,6 x 8	126	185	8,5	22
04 00193	Cruciform Bollard	CB-08	80	495	410	273,0 x 8,0	300	133,0 x 10	166	230	10,5	44
04 00194	Cruciform Bollard	CB-12	120	585	485	323,9 x 8,0	355	152,4 x 10	190	275	10,5	61
04 00195	Cruciform Bollard	CB-16	160	640	530	355,6 x 11,0	390	168,3 x 14,2	210	300	15	103
04 00196	Cruciform Bollard	CB-20	200	735	610	406,4 x 11,0	445	193,7 x 14,2	242	345	15	136
04 00197	Cruciform Bollard	CB-32	320	830	690	457,2 x 14,0	500	219,1 x 16	273	390	17	206

Standards: SEC parts standard
 Design safety factor: 5
 Material: S355J2G3 (EN 10025) St52-3 (DIN 17100)
 Optional materials: Stainless steel
 Standard finishing: Sandblasted, one layer of shopprimer
 Optional finishing: Galvanized