

Compressor type

L90, L140, L160, L190

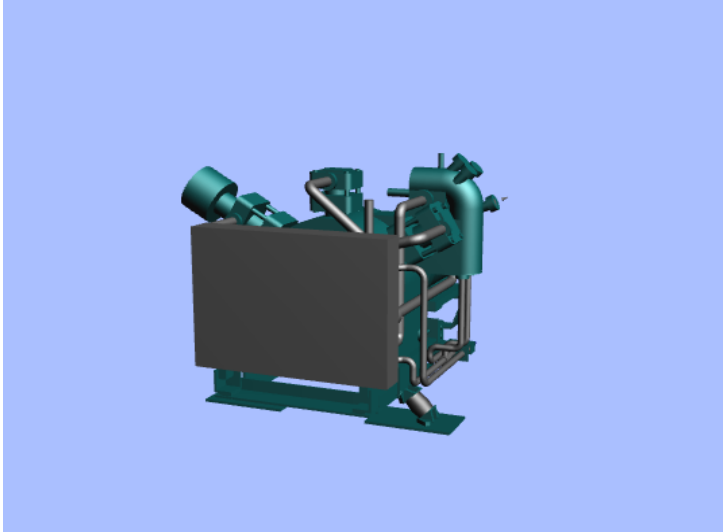

Structural features:

Three staged cylinders in 2x60° W-arrangement, with one-throw crankshaft, single acting trunk pistons

1st stage: 1 cylinder

2nd stage: 1 cylinder

3rd stage: 1 cylinder

Valves:

Combined suction and pressure valves in all stages

Air cooling:

By axial fan directly driven by the crankshaft

Intercooler and aftercooler:

Block type

Force feed lubrication:

Gear pump driven by the crankshaft by means of gear wheels

Oil pressure control by means of pressure gauge and pressure switch

Oil level inspection glass

Crankcase venting from oil filler to air suction filter

Oil filtration by external, exchangeable oil filter insert

Bearings:

Crankshaft: Slide bearings

Connecting rod: Slide bearings

Wrist pin: Needle bearings

Compressor type

L90, L140, L160, L190

HATLAPA

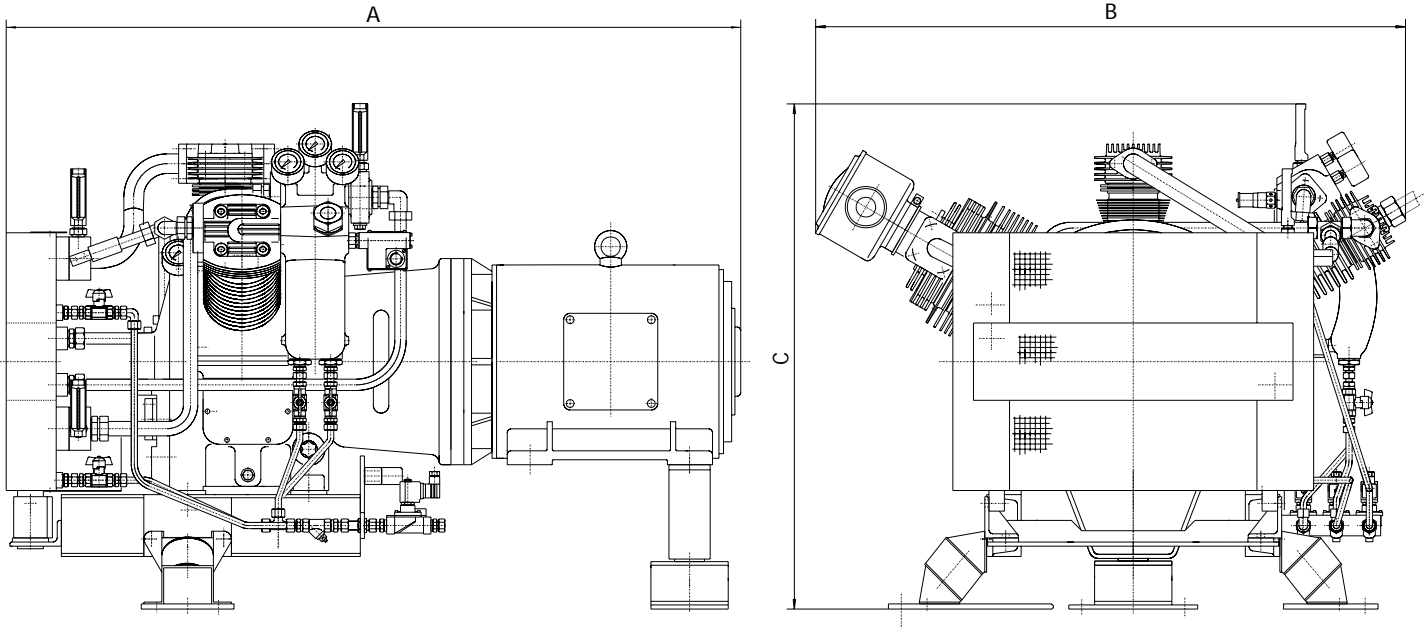

TYPE	Cylinders	Stages	Speed	F.A.D.	Power	Weight incl. e-motor approx. kg	Dimensions		
			r.p.m.	m ³ /h	kW		A	B	C
L90	3	3	1150	71	13.5	650	1485	1150	900
			1450	93	18.5	650	1457	1150	900
			1750	116	24	650	1485	1150	900
L140	3	3	1150	101	19.5	700	1520	1150	900
			1450	127	26,8	700	1520	1150	900
			1750	154	33,5	700	1520	1150	900
L160	3	3	1150	118	23	750	1612	1110	950
			1450	151	30	750	1612	1110	950
			1750	185	40	850	1605	1110	950
L190	3	3	1150	135	25	750	1612	1110	950
			1450	175	34.5	850	1605	1110	950
			1750	215	46.5	900	1635	1110	950

All data apply to a final pressure of 30 bar. The right for alteration of specification and data to incorporate improvements in design is reserved.

- Motor ①
- Flywheel and coupling ②
- Solenoid valve for draining ③
- Non-return valve ④
- Pressure switch ⑤
- Oil and water separator ⑥
- Flexible hoses ⑦

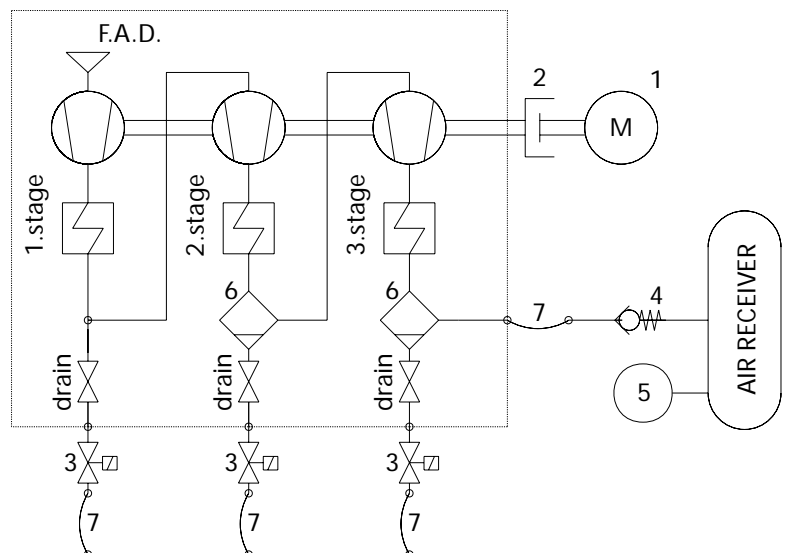

Drawings Compressor type L90, L140, L160, L190

