

Compressor type
L20, L35

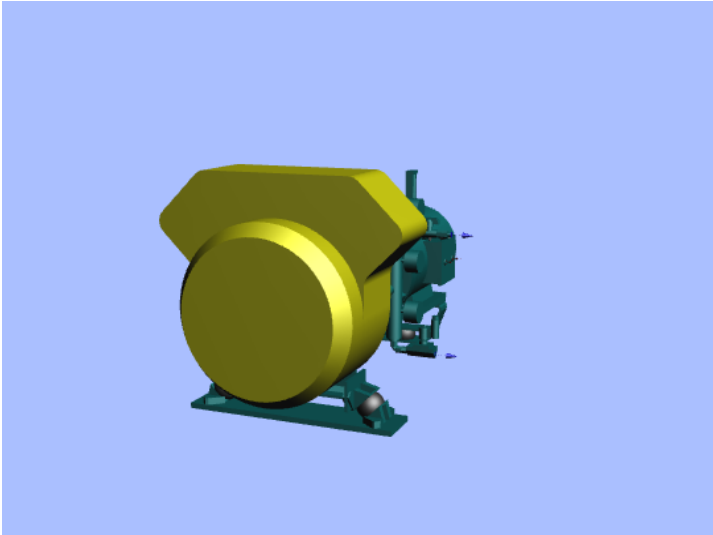

Structural features:

Two staged cylinders in 90° V-arrangement, with one-throw crankshaft, single acting trunk pistons

1st stage: 1 cylinder

2nd stage: 1 cylinder

Valves:

Combined suction and pressure valves in both stages

Air cooling:

By radial fan directly driven by the crankshaft

Intercooler and aftercooler:

Finned pipes

Force feed lubrication:

Gear pump directly driven by the crankshaft

Oil pressure control by means of pressure gauge and pressure switch

Oil level inspection glass

Crankcase venting from oil filler to air suction filter

Bearings:

Crankshaft: Slide bearings

Connecting rod: Slide bearings

Wrist pin 1st stage: Slide bearing

Wrist pin 2nd stage: Needle bearing

Compressor type

L20, L35

HATLAPA

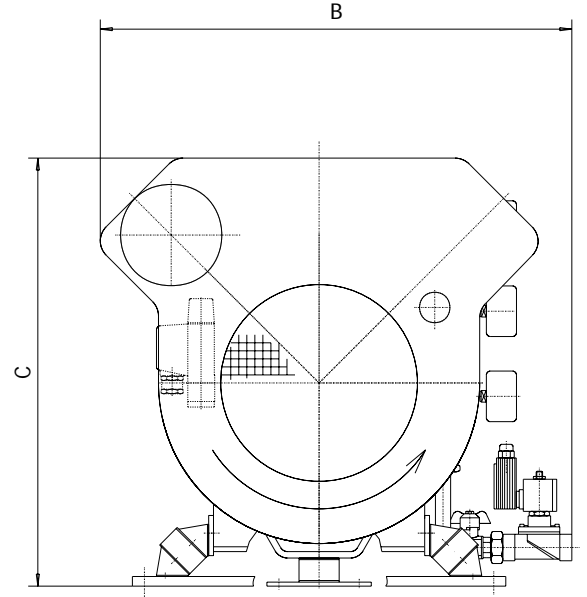
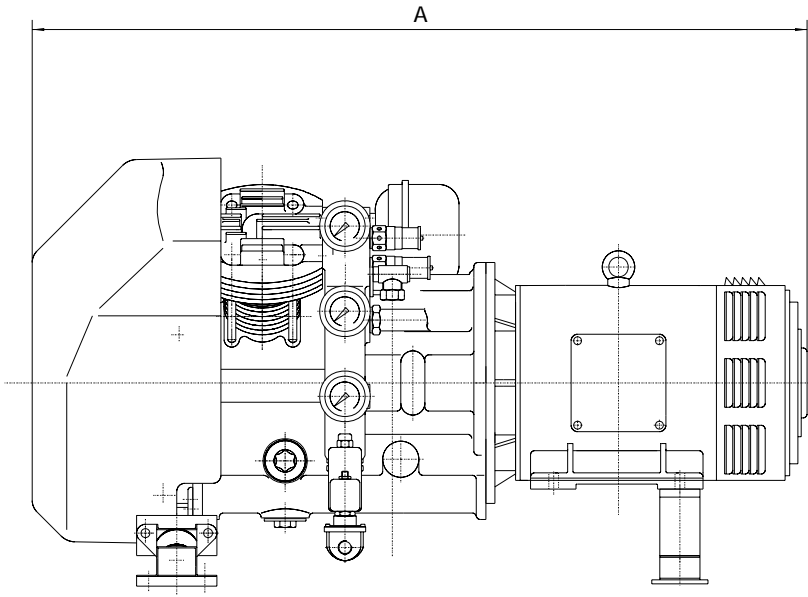

TYPE	Cylinders	Stages	Speed	F.A.D.	Power	Weight incl. e-motor approx. kg	Dimensions		
			r.p.m.	m ³ /h	kW		A	B	C
L20	2	2	1150	16.5	3.5	170	912	540	570
			1450	20.5	4.4	170	912	540	570
			1750	25	5.5	170	912	540	570
L35	2	2	1150	24	5.0	200	975	590	530
			1450	31	6.6	200	975	590	530
			1750	38	8.2	200	975	590	530

All data apply to a final pressure of 30 bar. The right for alteration of specification and data to incorporate improvements in design is reserved.

- Motor ①
- Flywheel and coupling ②
- Solenoid valve for draining ③
- Non-return valve ④
- Pressure switch ⑤
- Oil and water separator ⑥
- Flexible hoses ⑦

